

## temperature measurement

### resistance thermometer WTR 295 as pipe-mounted sensor

#### features

- resistance thermometer as a pipe-mounted sensor
- sensor can be fitted with every clamp, cable ties etc.
- different cable materials possible

#### technical specifications

- housing sensor made of stainless steel
- housing attachment of POM-plastic
- different connection lines possible
- standard temperature range: -50 °C to +80 °C



WTR 295-6-A-02PVC-1A3

#### product benefits

- For the most cost-effective measurement of surface temperatures of solid bodies

#### technical drawing

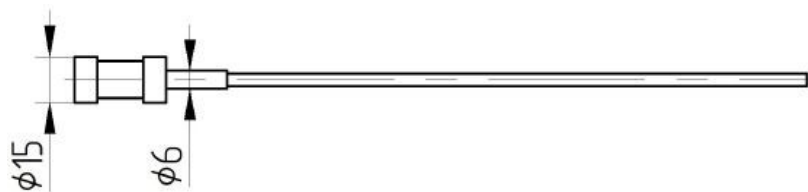
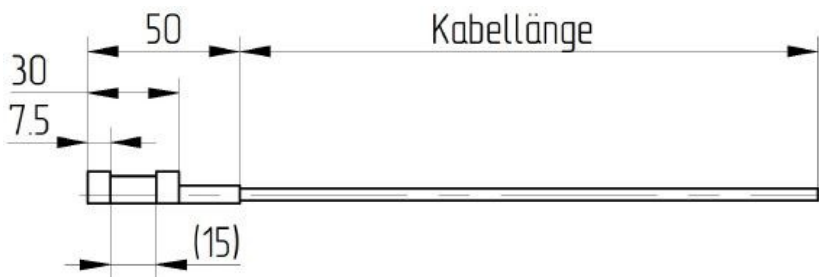

## temperature measurement

order-code WTR 295...

order example: WTR 295-A1-03-1A3

### sensor diameter and/or process connection

-6 sensor diameter 6 mm

### sensor length

-A sensor length 50 mm

-K sensor length according to customer requirements (please specify lengths)

### cable length and -material (observe temperature range)

-00PVC specify cable length (e. g. 02 = 2 m) / m, cable material PVC (temperature range standard +80°C)

-00PUR specify cable length (e. g. 02 = 2 m) / m, cable material PUR (temperature range to +80°C)

-00S specify cable length (e. g. 02 = 2 m) / m, cable material silicone (temperature range to +80°C)

### types of sensor and tolerance

-1A2 1xPT100 class A 2-wire

-1A3 1xPT100 class A 3-wire

-1A4 1xPT100 class A 4-wire

-2A2 2xPT100 class A 2-wire

-2A3 2xPT100 class A 3-wire

-1(1/3DIN)3 1xPT100 3-wire 1/3 DIN tolerance

-2(1/3DIN)3 2xPT100 3-wire 1/3 DIN tolerance

-1A2/PT1000 1xPT1000 2-wire

-NI1000 1 x NI1000 sensor TK6180

-KTY81-110 1 x KTY81-110 sensor

-KTY81-210 1 x KTY81-210 sensor

-KX other types of sensor and tolerances on customer's request

### optional (several possible)

-WS with additional shrink tubing, transition sensor to cable

-WD waterproof potted

-Vapour vapour-tight potted